

GENERAL SPECIFICATIONS	
IGNITION TYPE	WASTED SPARK
MAX. INPUT RPM	3500 RPM
OPERATING TEMPERATURE RANGE	-38°C TO +107°C
VOLTAGE INPUT RANGE	8.5 - 30 V <sub>DC</sub>
OPERATING POWER REQUIREMENTS @ 2700 RPM	1.00±0.2 A @ 14 V <sub>DC</sub> 0.50±0.2 A @ 28 V <sub>DC</sub>
MANIFOLD PRESSURE INPUT RANGE	5 - 45 inHg
TIMING ACCURACY	±2°
BUILD	surefly_6_18041702_1yc.zip
CHECKSUM	0057291B

REVISIONS				
ZONE	REV.	DESCRIPTION	DATE	APPROVED
ALL	PT-1	PROTOTYPE 1	04/14/2017	RVC
ALL	PT-2	PROTOTYPE 2	06/01/2017	RVC
ALL	IR	INITIAL RELEASE FOR PRODUCTION	05/21/2018	RVC
ALL	A	ECO 19-001	03/25/2019	RVC
ALL	B	ECO 20-001	03/30/2020	RVC

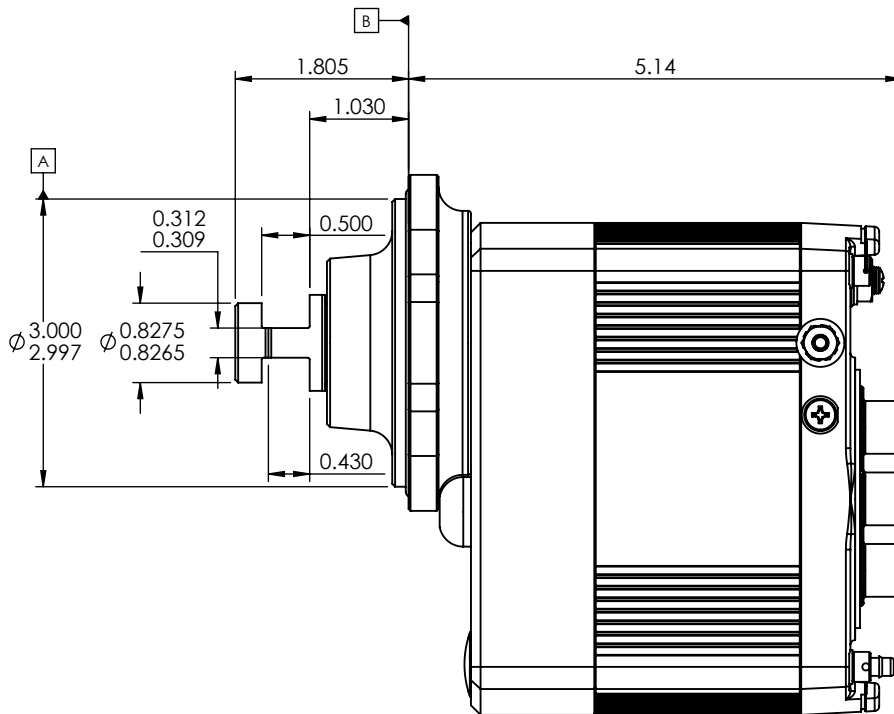

ENGINE TIMING	IGNITION ROTATION	TIMING OPTION	DIP SWITCH				LED CODE ON=SHORT OFF=LONG 1/2=SECOND =ERROR	TIMING SCHEDULE
			1	2	3	4		
			L=OFF R=ON	V=OFF F=ON	20°=OFF-OFF 23°=OFF-ON 25°=ON-OFF	1/2=SECOND =ERROR		
20°	LEFT (L)(LN)	VARIABLE	OFF	OFF	OFF	OFF	----	A-20
	LEFT (L)(LN)	FIXED	OFF	ON	OFF	OFF	----	F-20
	RIGHT (R)(RN)	FIXED	ON	ON	OFF	OFF	----	F-20
23°	LEFT (L)(LN)	VARIABLE	OFF	OFF	OFF	ON	----	A-23
	LEFT (L)(LN)	FIXED	OFF	ON	OFF	ON	----	F-23
25°	LEFT (L)(LN)	VARIABLE	OFF	OFF	ON	OFF	----	A-25
	LEFT (L)(LN)	FIXED	OFF	ON	ON	OFF	----	F-25
	RIGHT (R)(RN)	VARIABLE	ON	OFF	ON	OFF	----	A-25
	RIGHT (R)(RN)	FIXED	ON	ON	ON	OFF	----	F-25

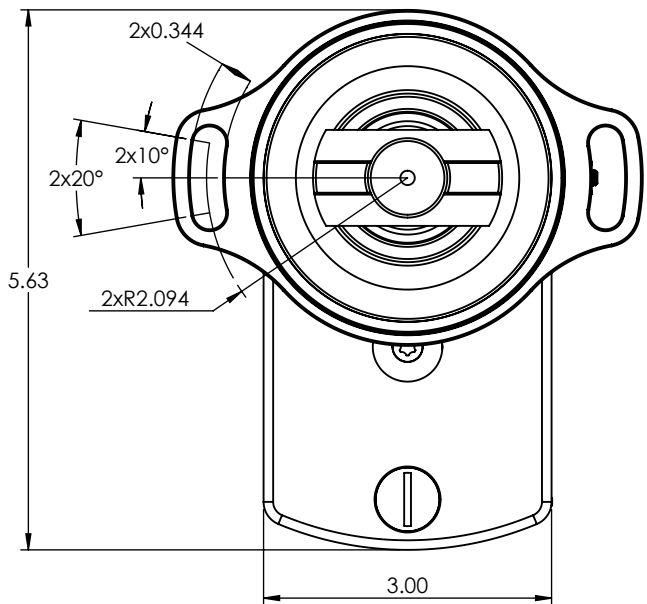
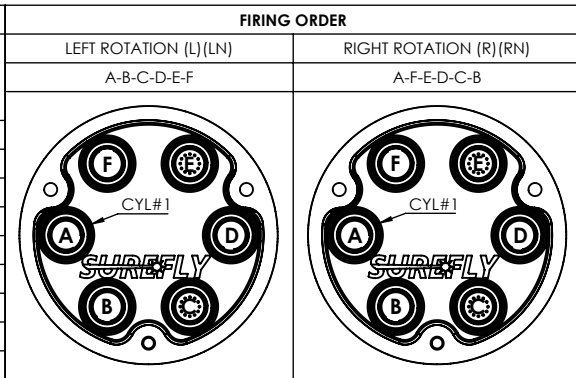

**SureFly**  
Granbury, Texas

**6 CYLINDER LYCOMING IGNITION**

SCALE: <b>1:2</b>	MATERIAL: N/A	FINISH: N/A
DIMENSIONS IN INCHES UNLESS OTHERWISE SPECIFIED		DRAWN BY: <b>R. CONDY</b>
TOLERANCES:		DATE: <b>05/21/2018</b>
ANGLES ±1°	0.X ±0.050	0.XX ±0.030
	0.XXX ±0.010	
SHEET: <b>1/1</b>		PART NO: <b>SIM6L</b>
		REV: <b>B</b>